

ELEVATION VIEW P1-P4      SCALE 1/2" = 1'

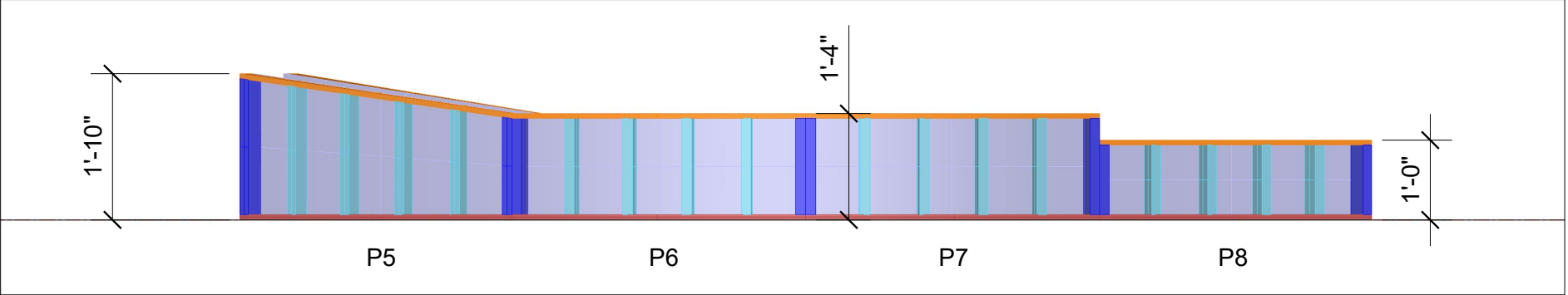

ELEVATION VIEW P5-P8      SCALE 1/2" = 1'

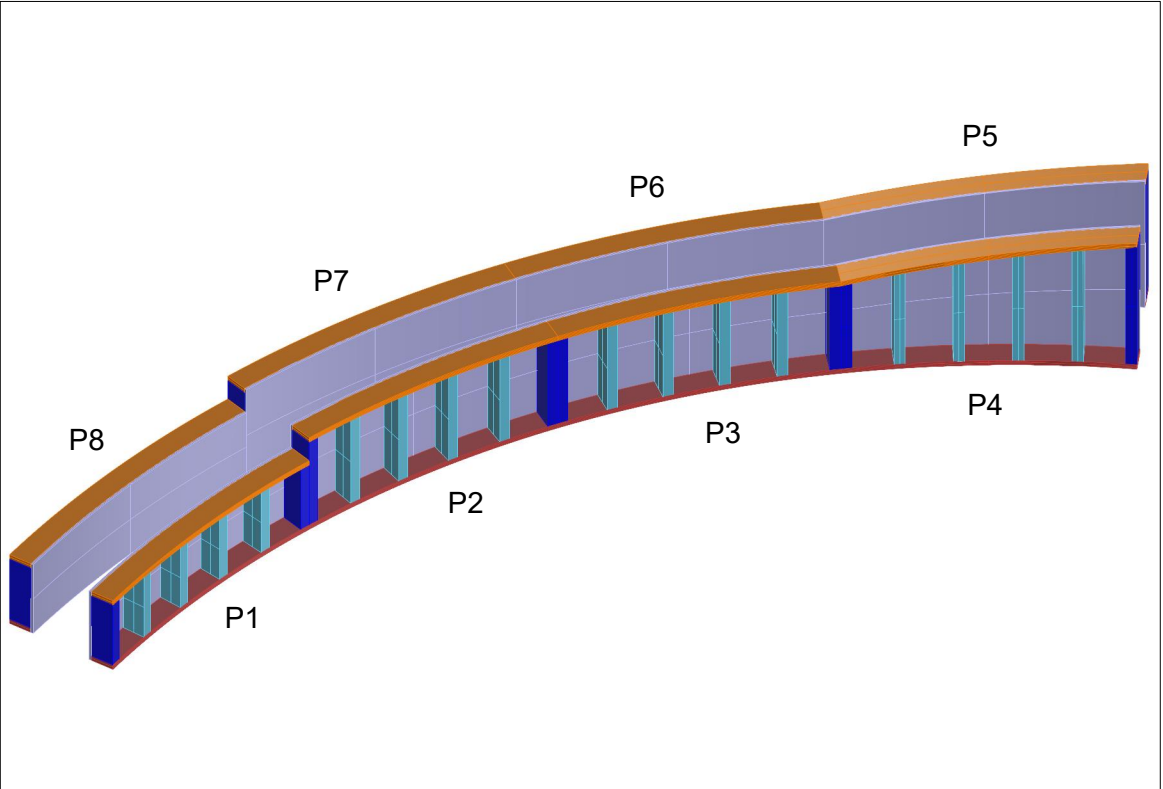

PANEL LAYOUT

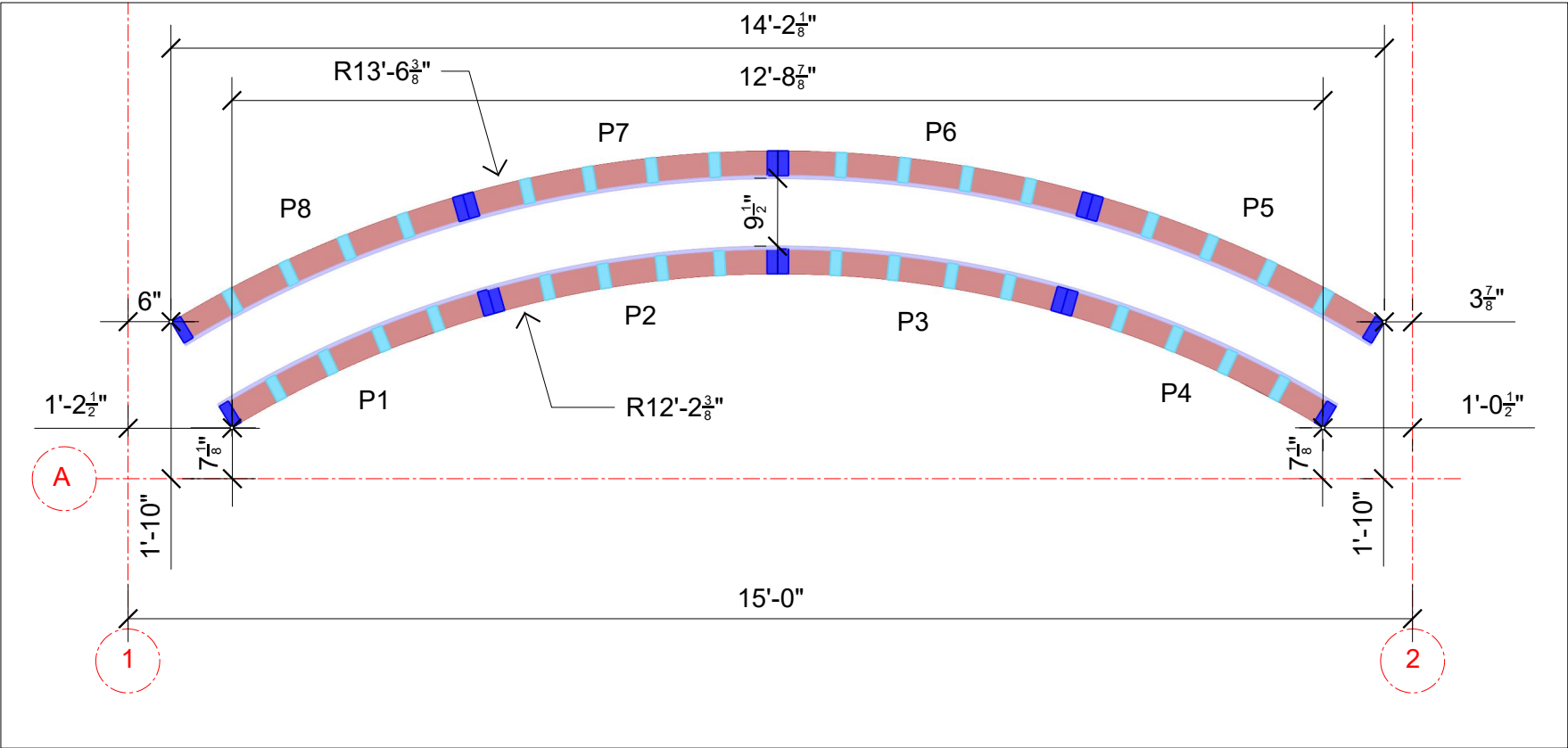

FORMWORK LAYOUT PLAN      SCALE 1/2" = 1'

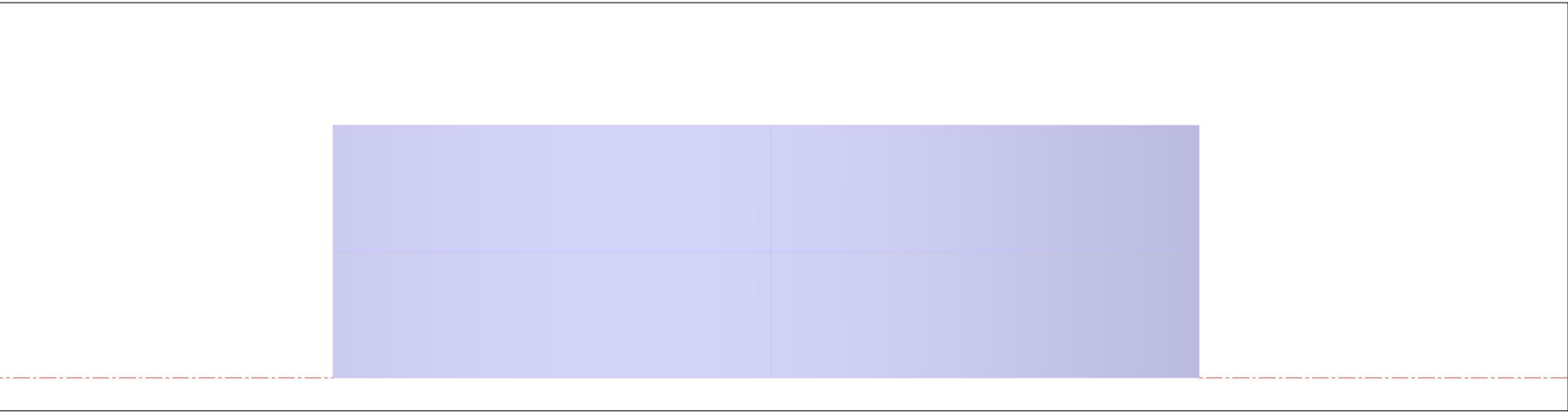

PANEL 1 CASTING FACE ELEVATION      SCALE 1-1/2" = 1'

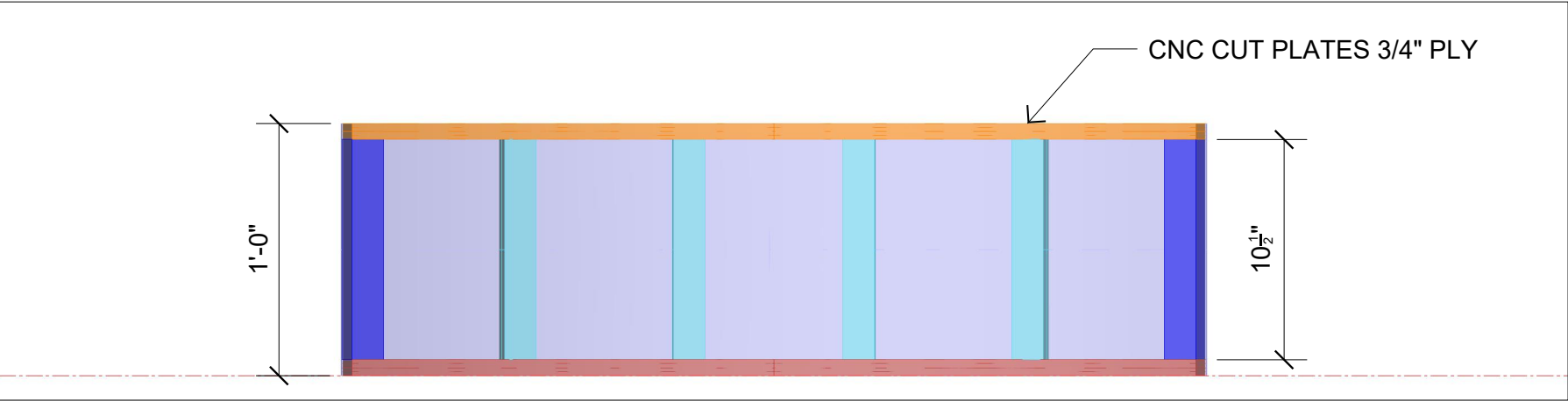

PANEL 1 FRAMING ELEVATION      SCALE 1-1/2" = 1'

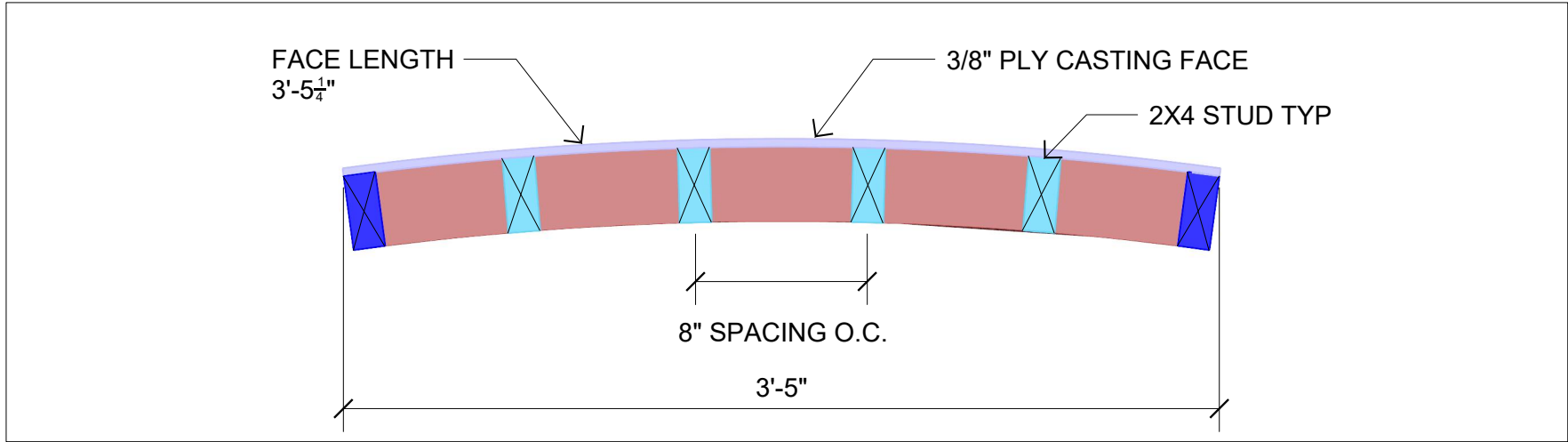

PANEL 1 PLAN      SCALE 1-1/2" = 1'

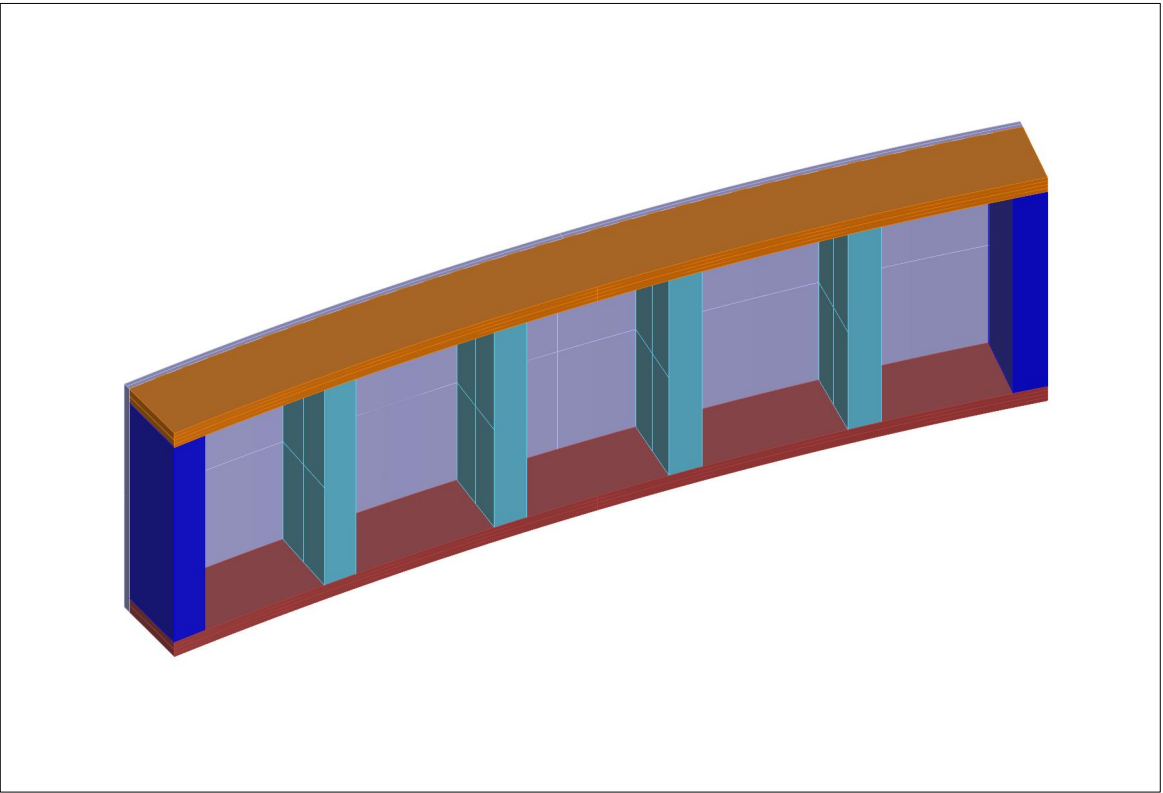

PANEL 1 LAYOUT

GENERAL NOTES

- 1. ATTACH STUDS TO PLATES USING 2 FASTENERS
- 2. ATTACH CASTING FACE TO FRAMING UTILIZING TWO SCREWS PER STUD, ONE INTO THE UPPER REGION OF THE STUD AND ONE IN THE LOWER.

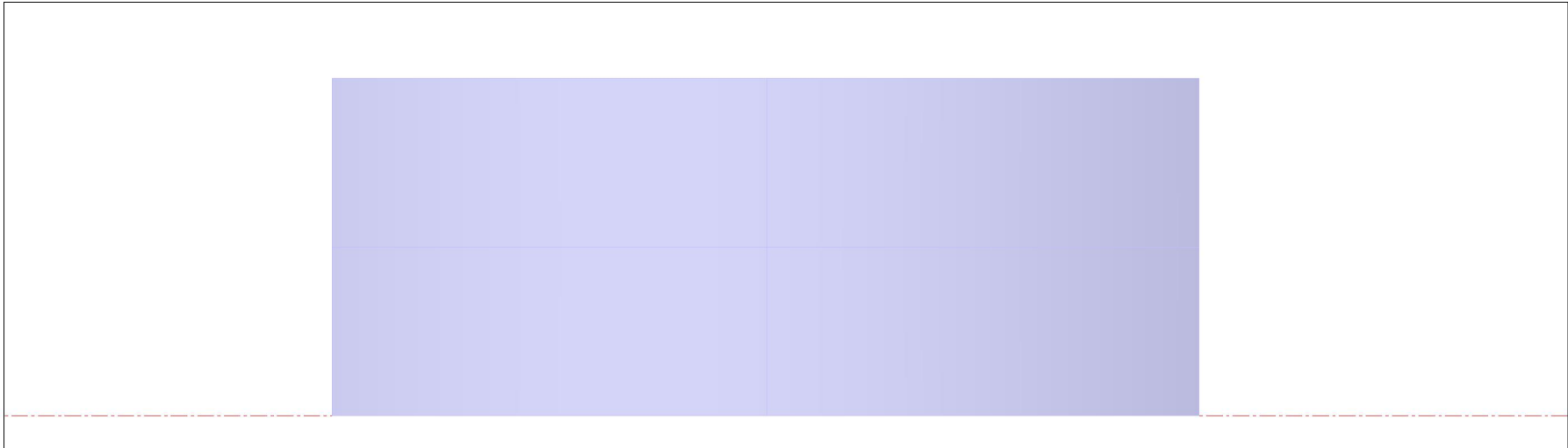

PANEL 2 CASTING FACE ELEVATION      SCALE 1-1/2" = 1'

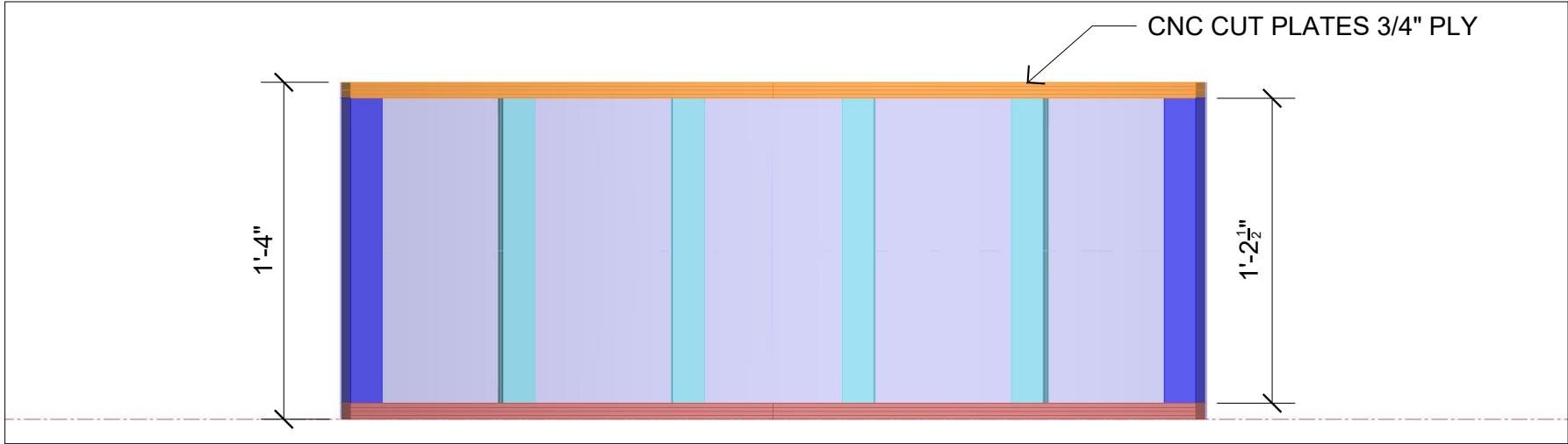

PANEL 2 FRAMING ELEVATION      SCALE 1-1/2" = 1'

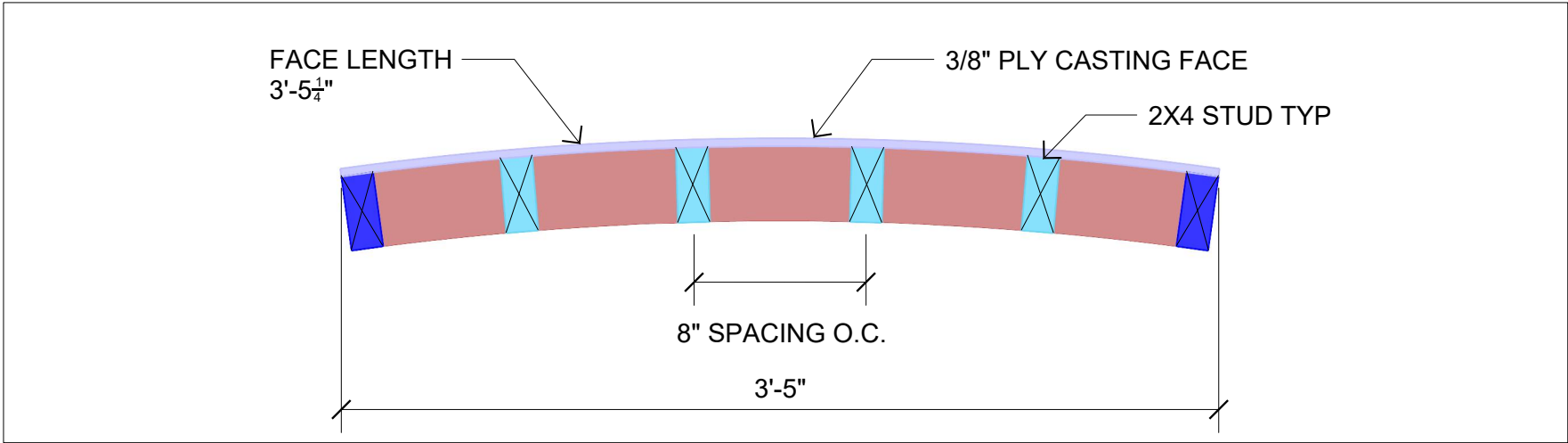

PANEL 2 PLAN      SCALE 1-1/2" = 1'

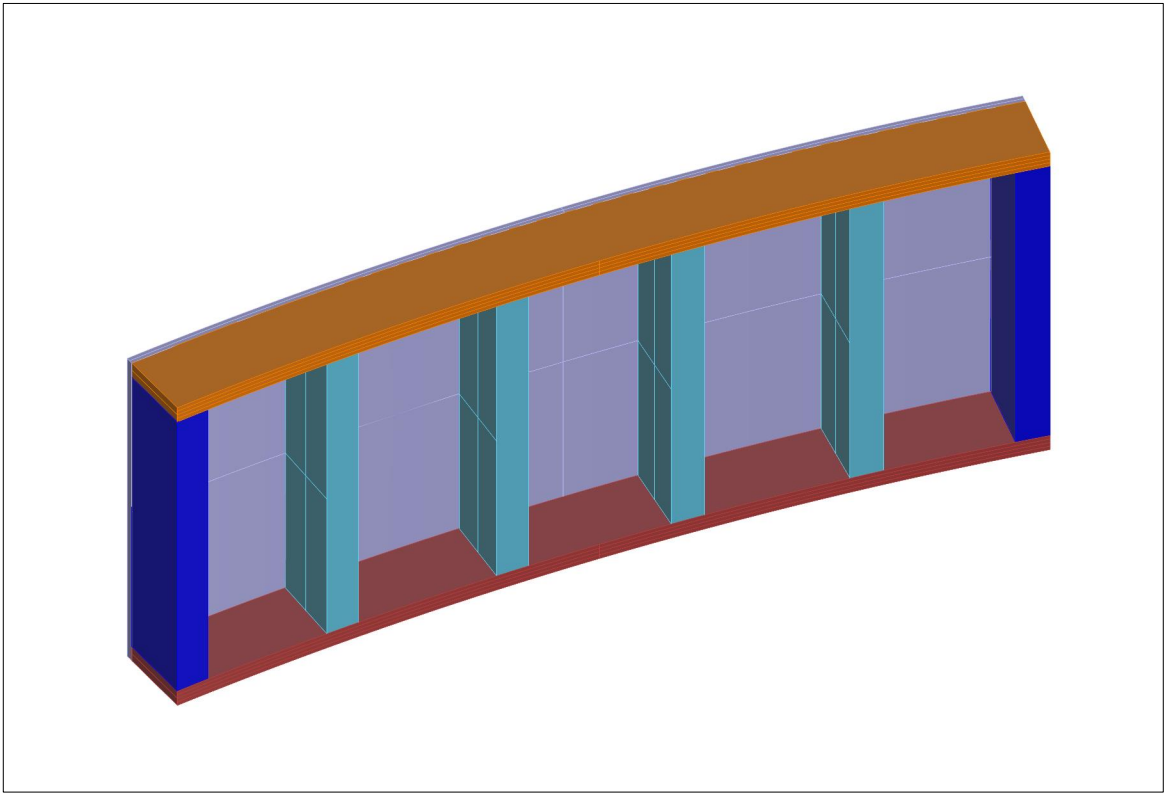

PANEL 2 LAYOUT

GENERAL NOTES

- 1. ATTACH STUDS TO PLATES USING 2 FASTENERS
- 2. ATTACH CASTING FACE TO FRAMING UTILIZING THREE SCREWS PER STUD, ONE INTO THE UPPER REGION OF THE STUD, ONE IN THE CENTER, AND ONE IN THE LOWER.

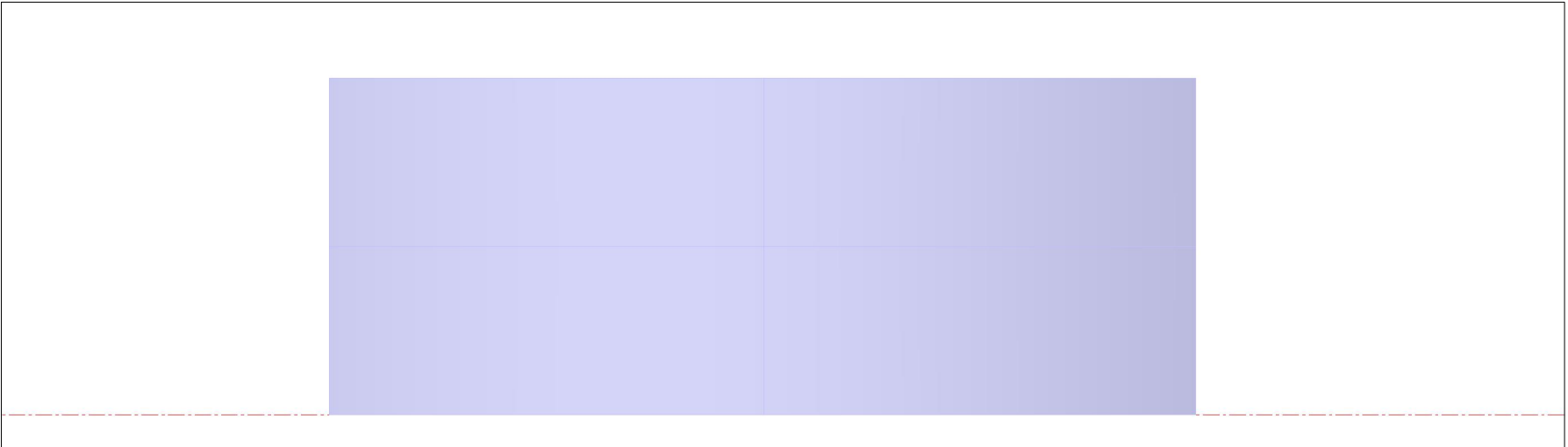

PANEL 3 CASTING FACE ELEVATION      SCALE 1-1/2" = 1'

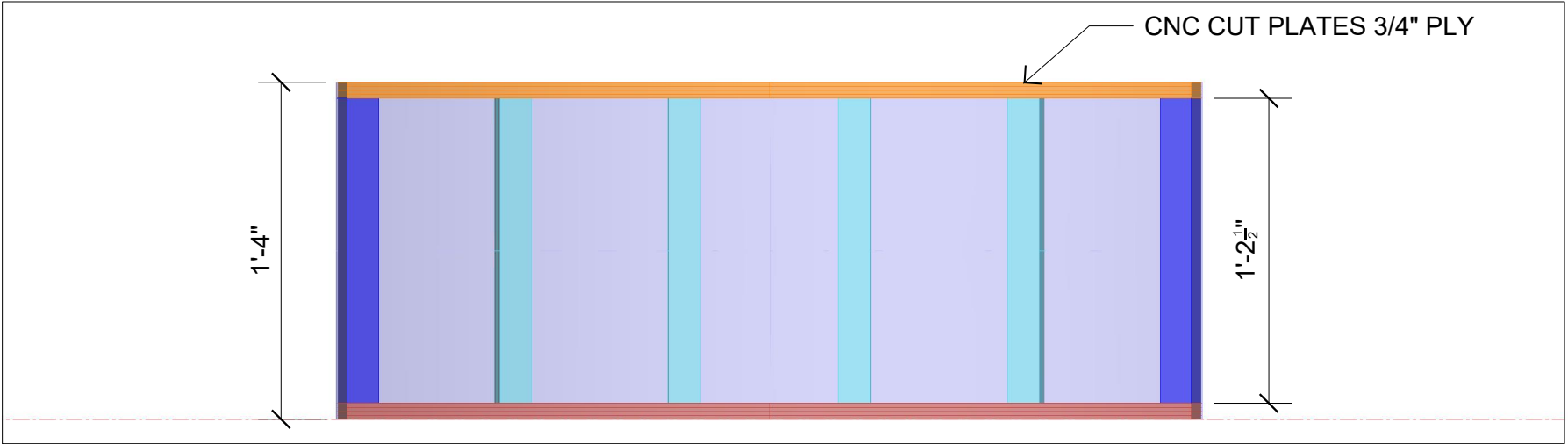

PANEL 3 FRAMING ELEVATION      SCALE 1-1/2" = 1'

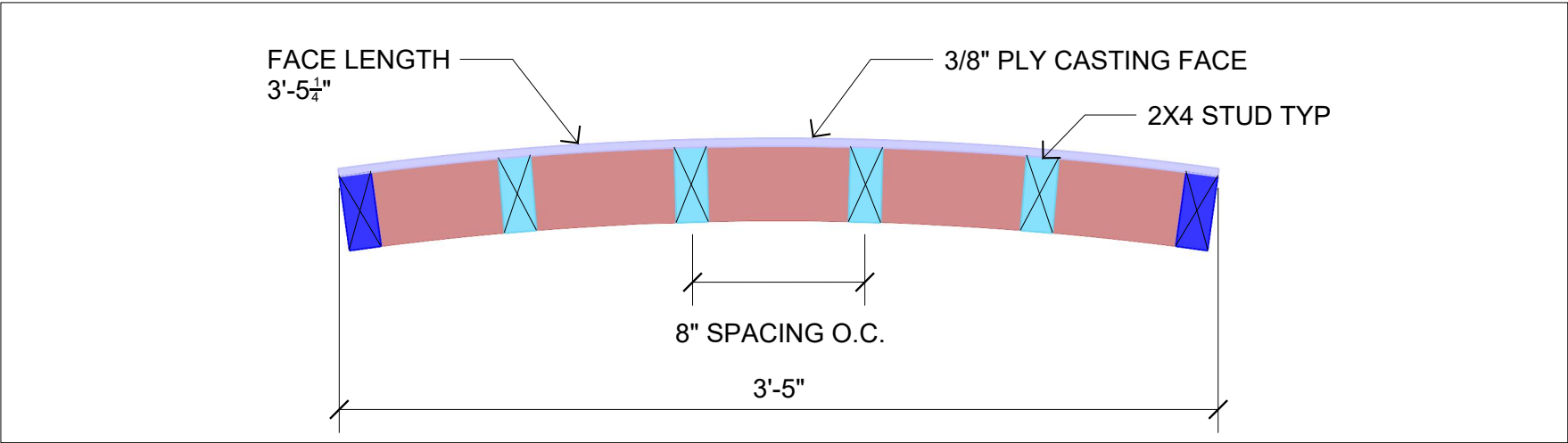

PANEL 3 PLAN      SCALE 1-1/2" = 1'

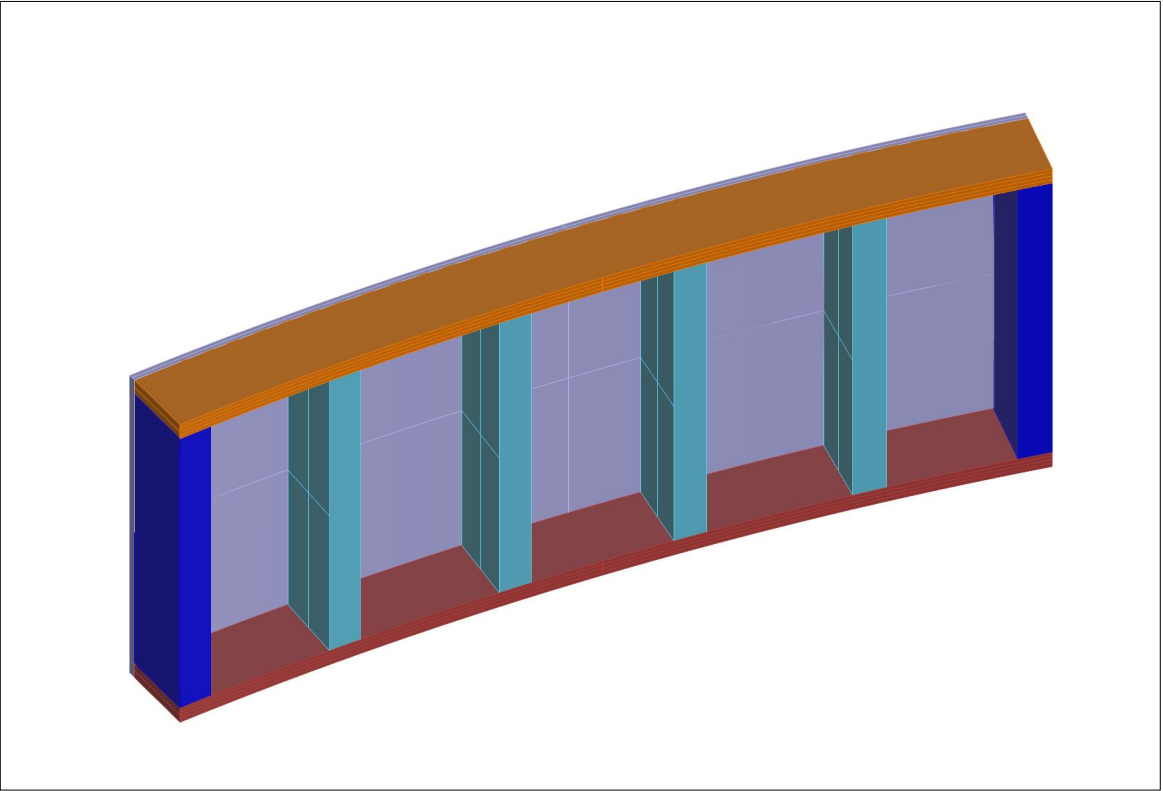

PANEL 3 LAYOUT

GENERAL NOTES

- 1. ATTACH STUDS TO PLATES USING 2 FASTENERS
- 2. ATTACH CASTING FACE TO FRAMING UTILIZING THREE SCREWS PER STUD, ONE INTO THE UPPER REGION OF THE STUD, ONE IN THE CENTER, AND ONE IN THE LOWER.

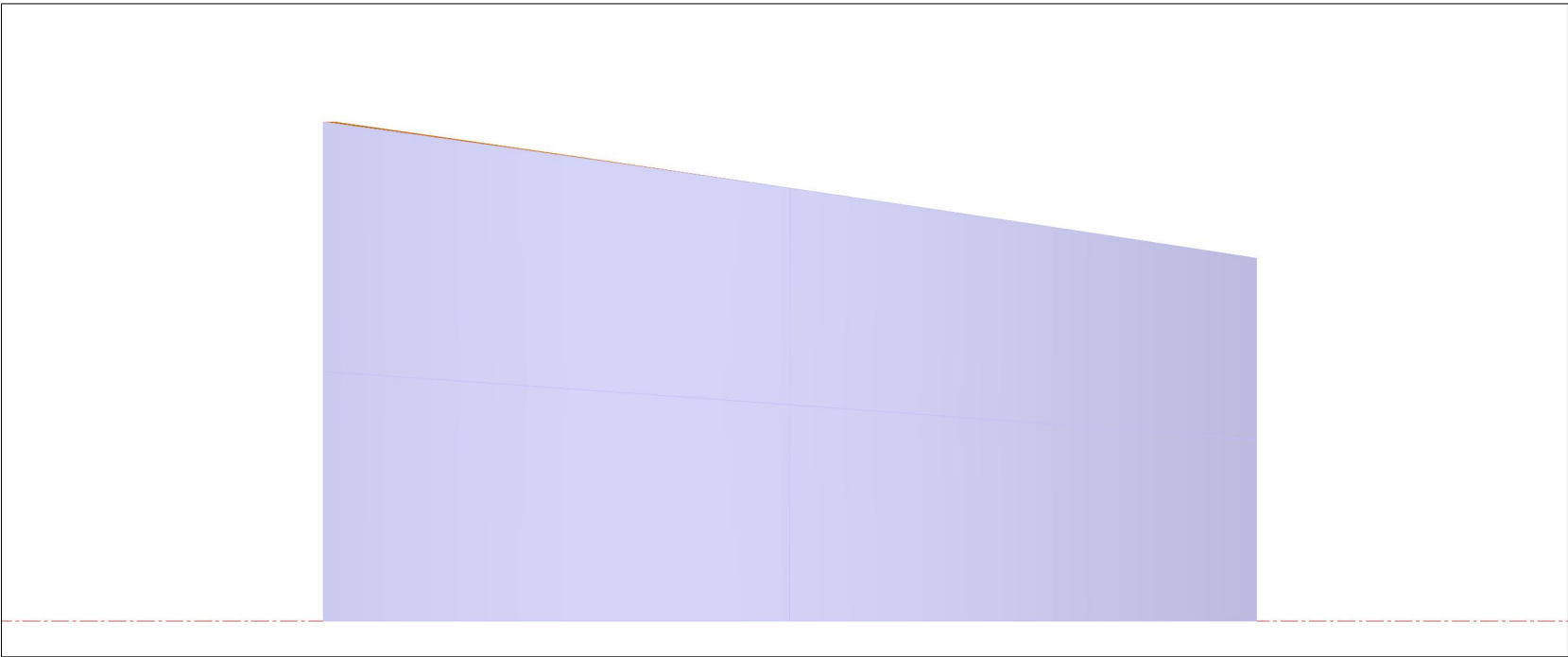

PANEL 4 CASTING FACE ELEVATION      SCALE 1-1/2" = 1'

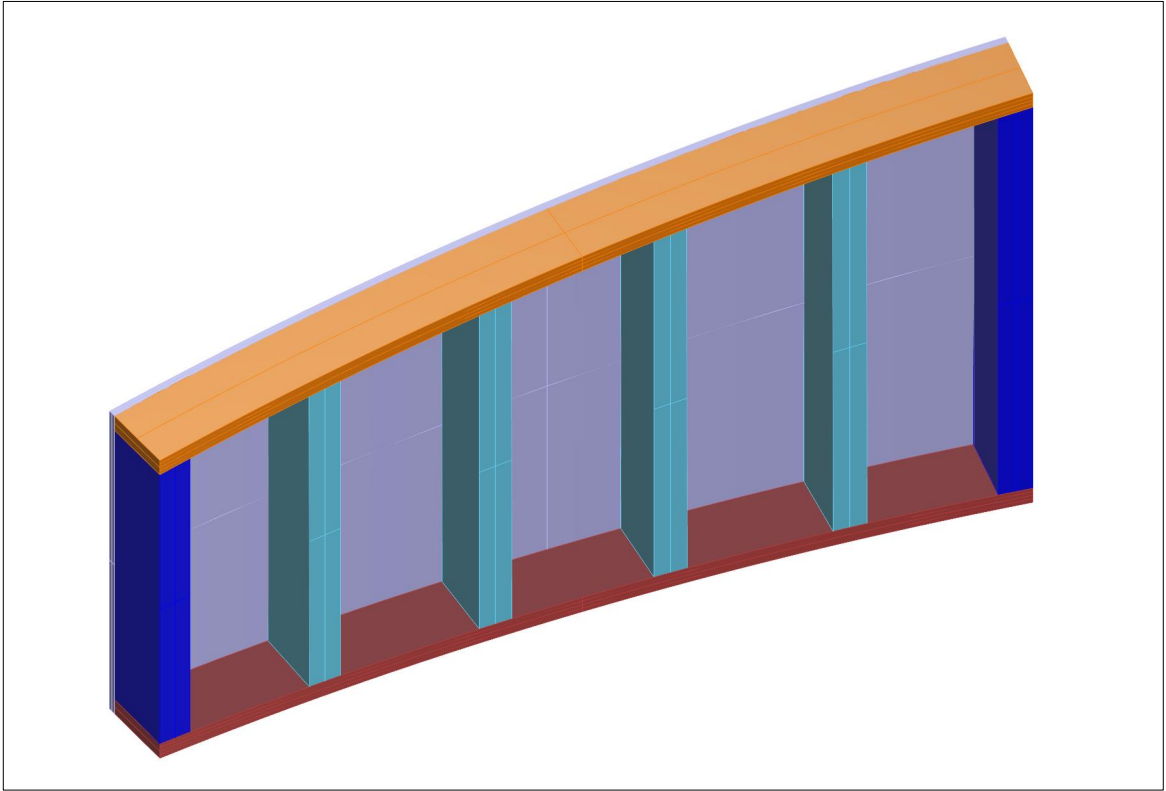

PANEL 4 LAYOUT

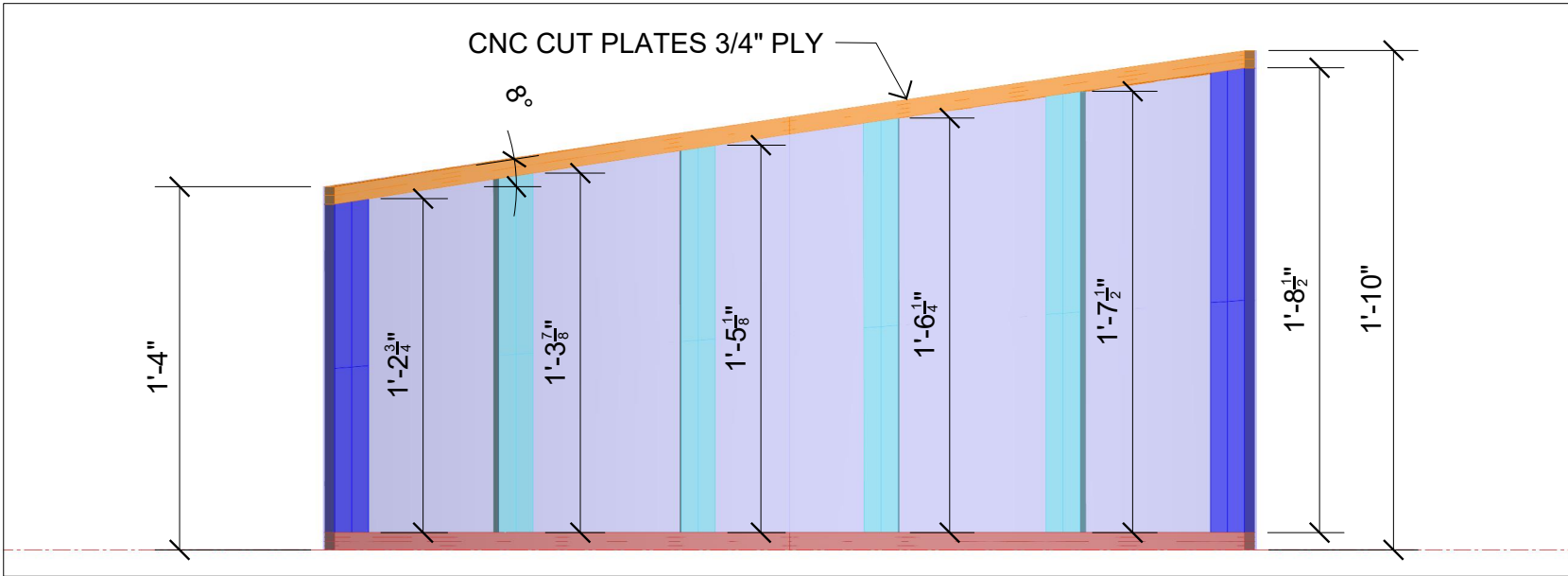

PANEL 4 FRAMING ELEVATION      SCALE 1-1/2" = 1'

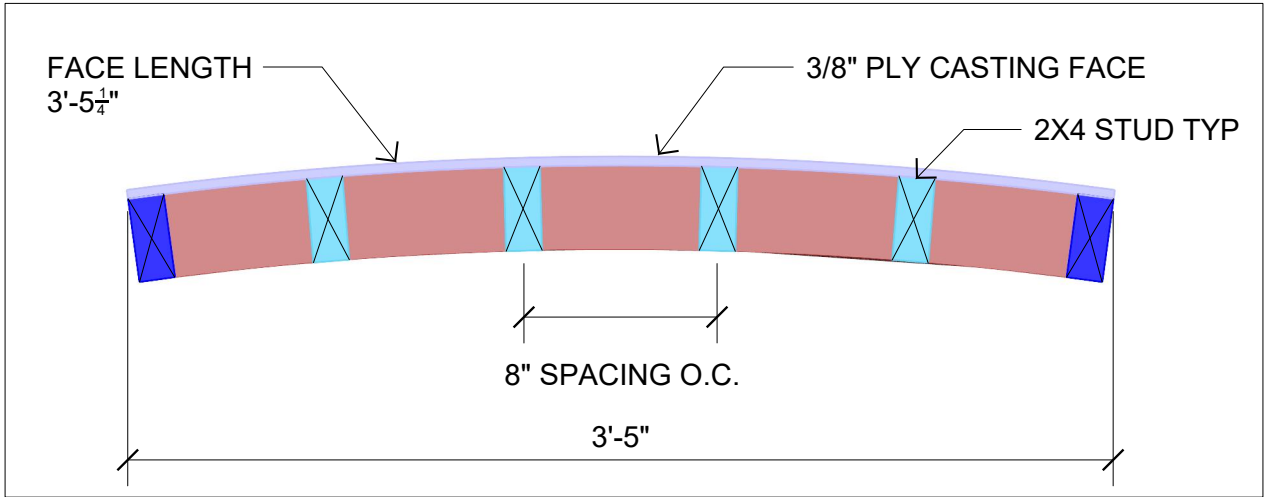

PANEL 4 PLAN      SCALE 1-1/2" = 1'

GENERAL NOTES

- 1. ATTACH STUDS TO PLATES USING 2 FASTENERS
- 2. ATTACH CASTING FACE TO FRAMING UTILIZING THREE SCREWS PER STUD, ONE INTO THE UPPER REGION OF THE STUD, ONE IN THE CENTER, AND ONE IN THE LOWER.

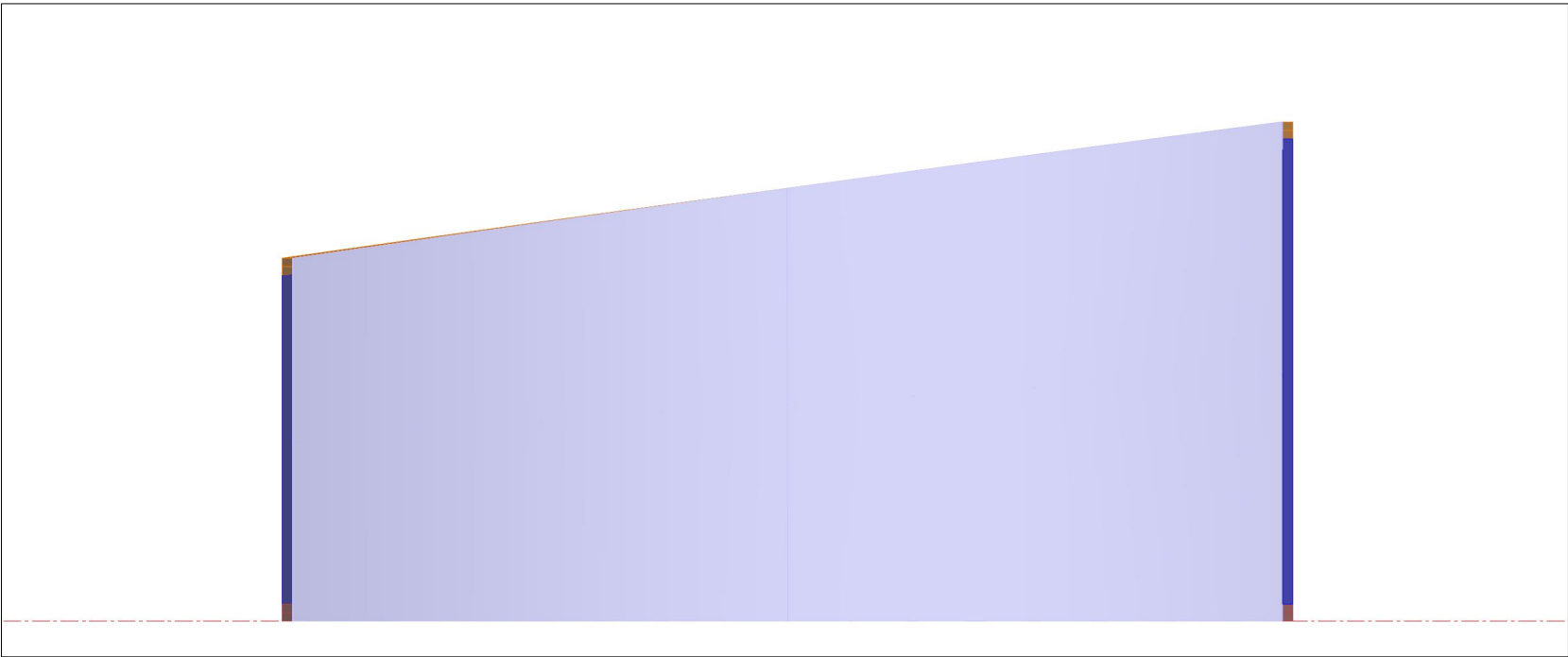

PANEL 5 CASTING FACE ELEVATION      SCALE 1-1/2" = 1'

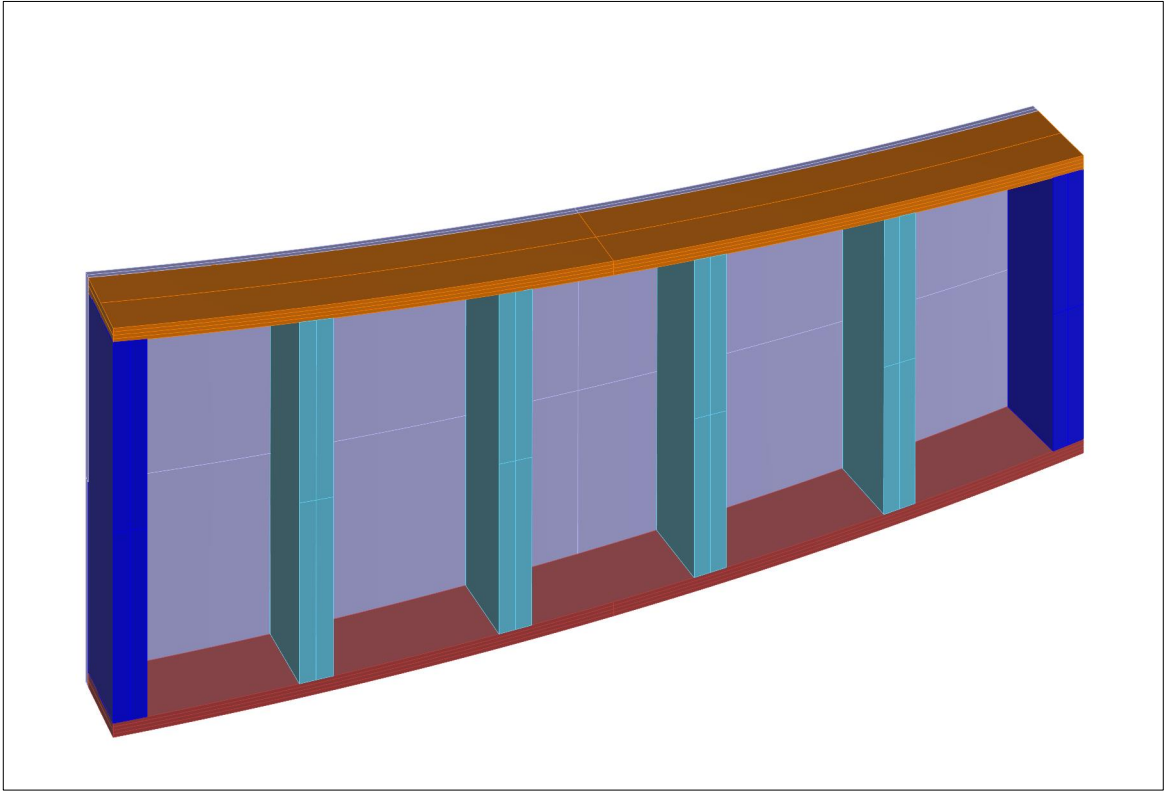

PANEL 5 LAYOUT

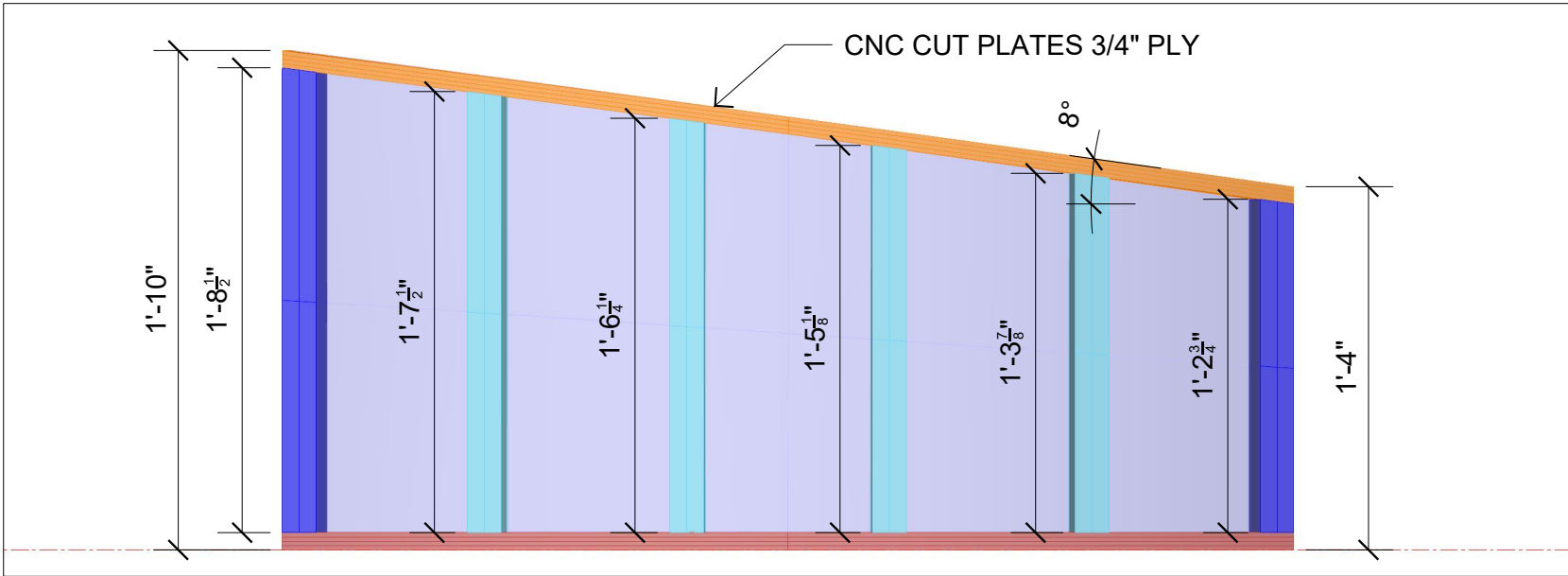

PANEL 5 FRAMING ELEVATION      SCALE 1-1/2" = 1'

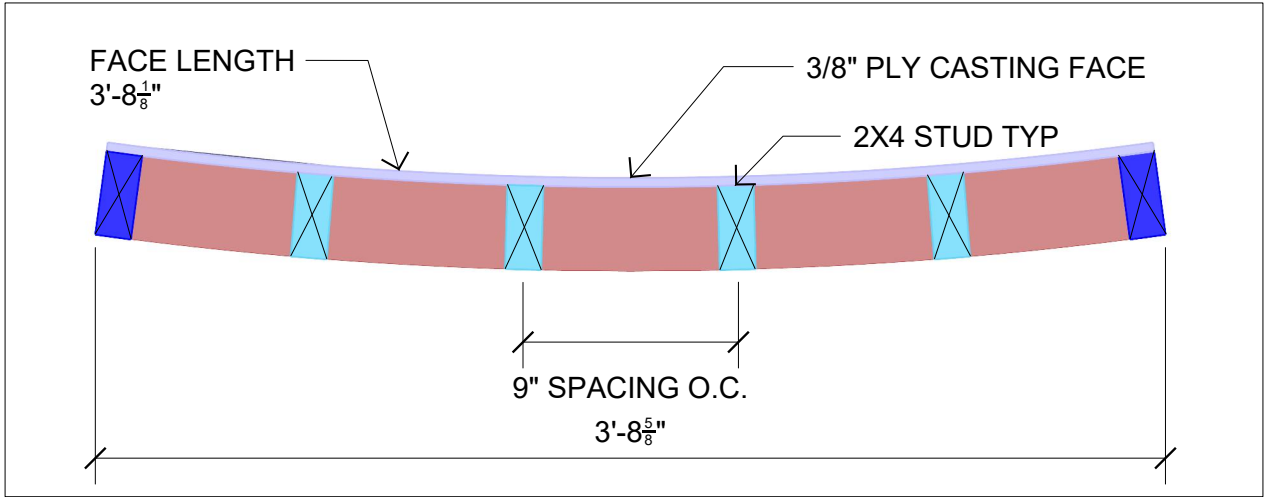

PANEL 5 PLAN      SCALE 1-1/2" = 1'

GENERAL NOTES

- 1. ATTACH STUDS TO PLATES USING 2 FASTENERS
- 2. ATTACH CASTING FACE TO FRAMING UTILIZING THREE SCREWS PER STUD, ONE INTO THE UPPER REGION OF THE STUD, ONE IN THE CENTER, AND ONE IN THE LOWER.



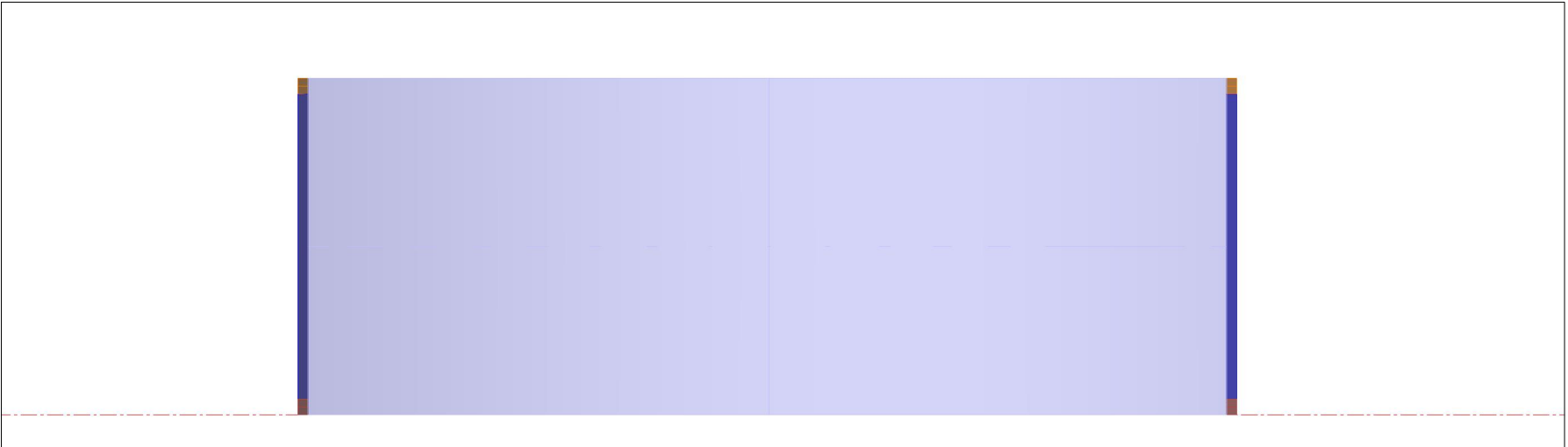

PANEL 6 CASTING FACE ELEVATION      SCALE 1-1/2" = 1'

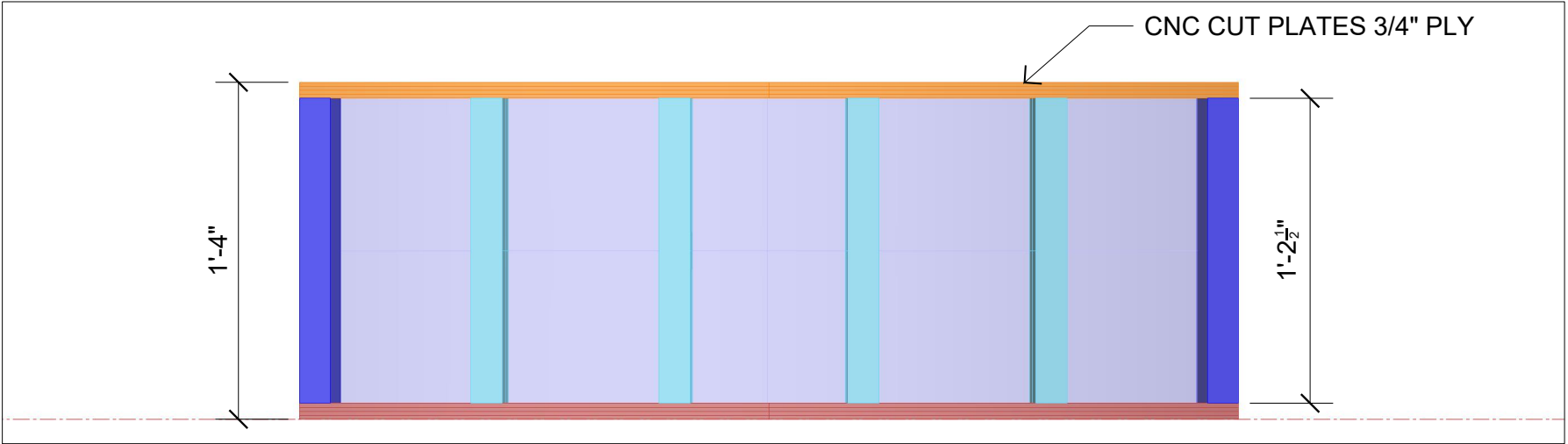

PANEL 6 FRAMING ELEVATION      SCALE 1-1/2" = 1'

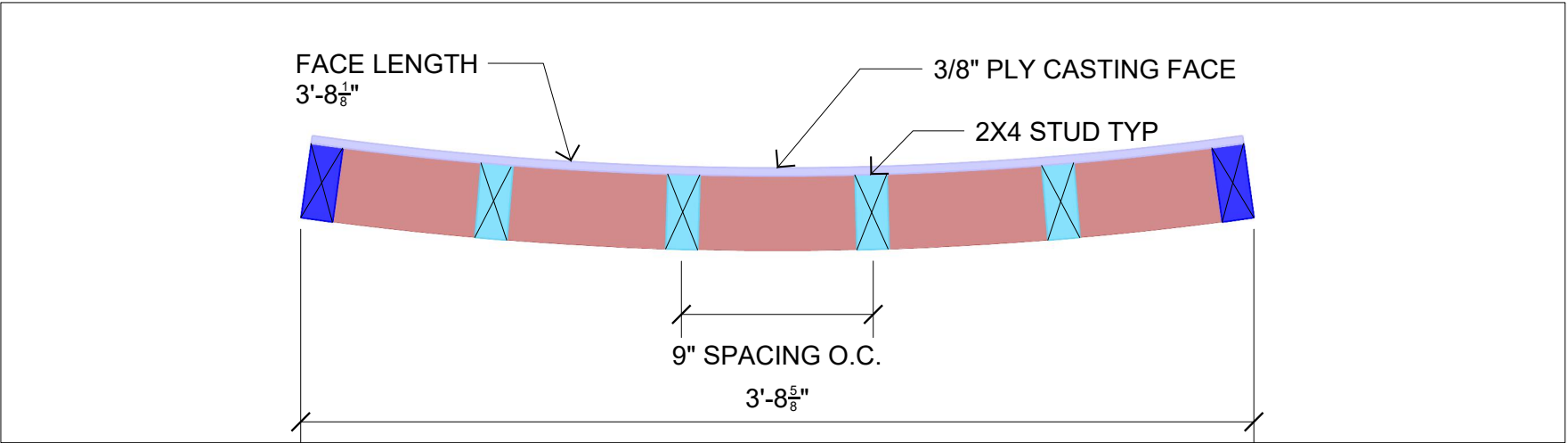

PANEL 6 PLAN      SCALE 1-1/2" = 1'

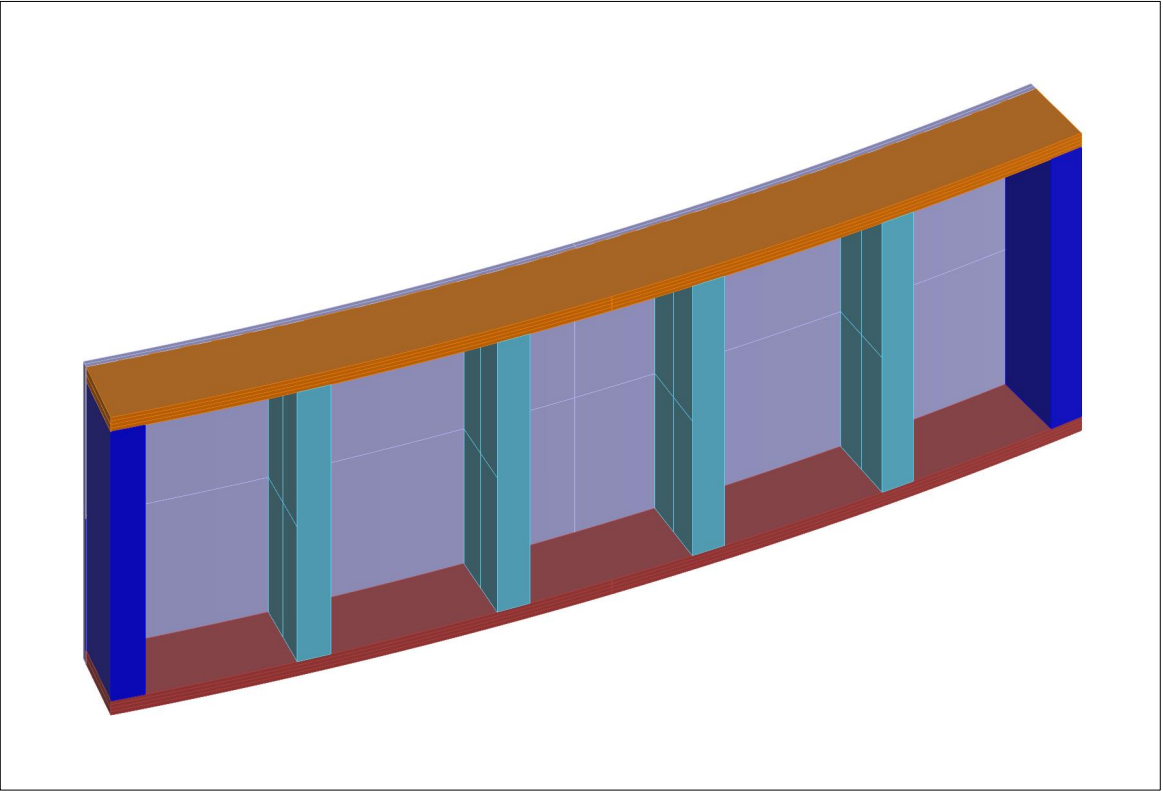

PANEL 6 LAYOUT

GENERAL NOTES

- 1. ATTACH STUDS TO PLATES USING 2 FASTENERS
- 2. ATTACH CASTING FACE TO FRAMING UTILIZING THREE SCREWS PER STUD, ONE INTO THE UPPER REGION OF THE STUD, ONE IN THE CENTER, AND ONE IN THE LOWER.

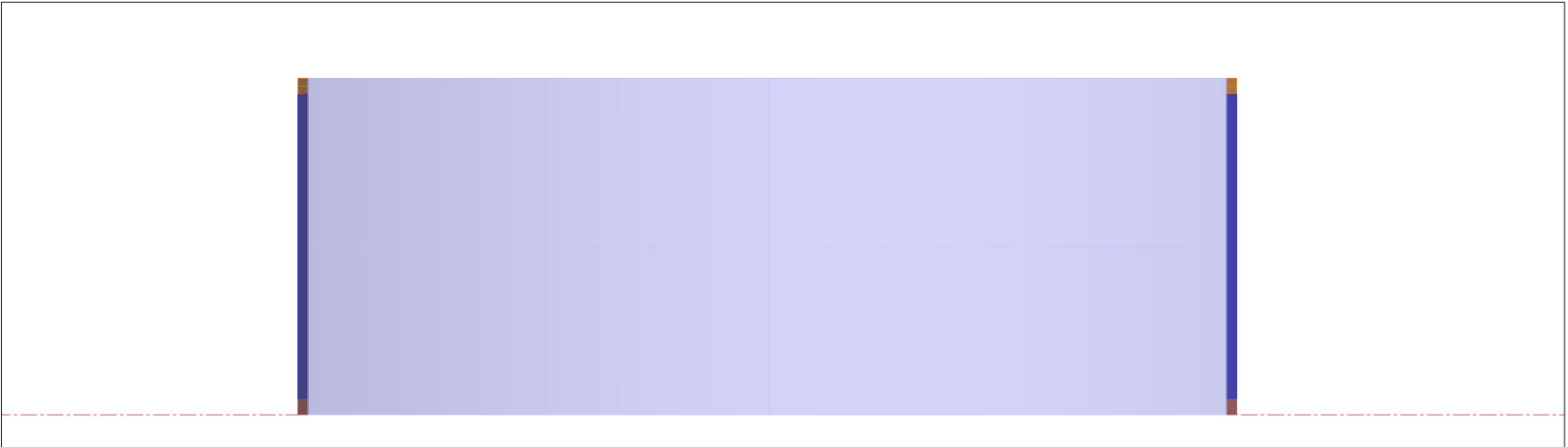

PANEL 7 CASTING FACE ELEVATION      SCALE 1-1/2" = 1'

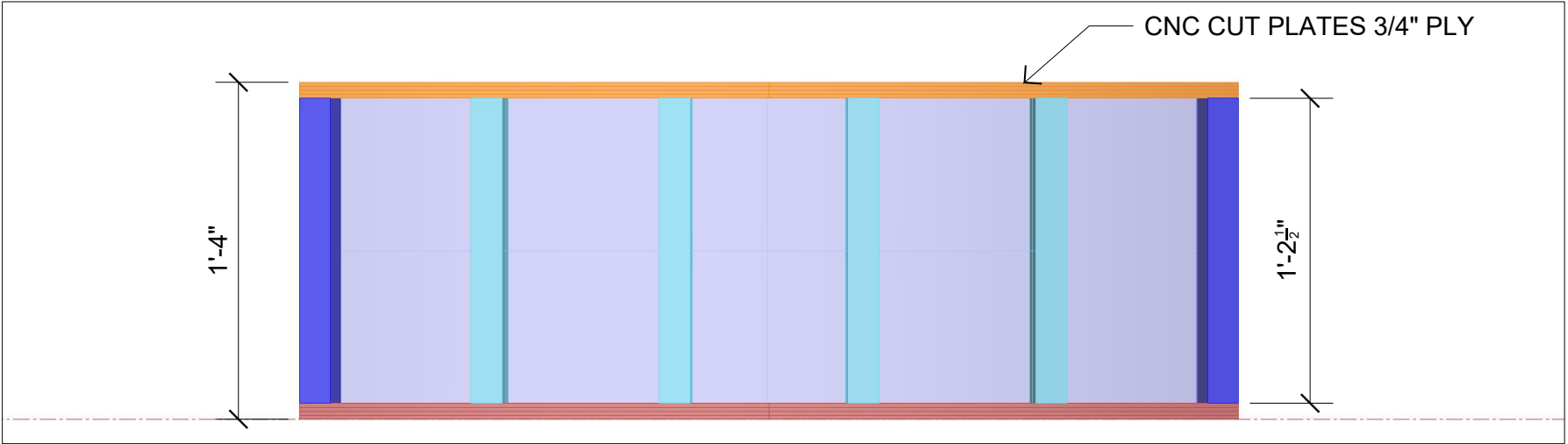

PANEL 7 FRAMING ELEVATION      SCALE 1-1/2" = 1'

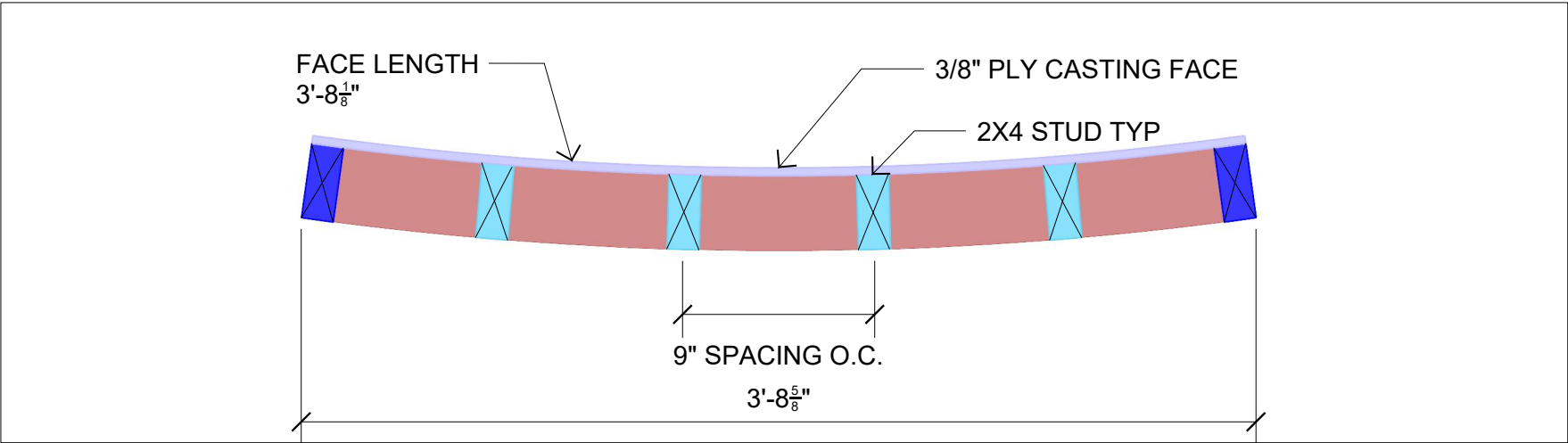

PANEL 7 PLAN      SCALE 1-1/2" = 1'

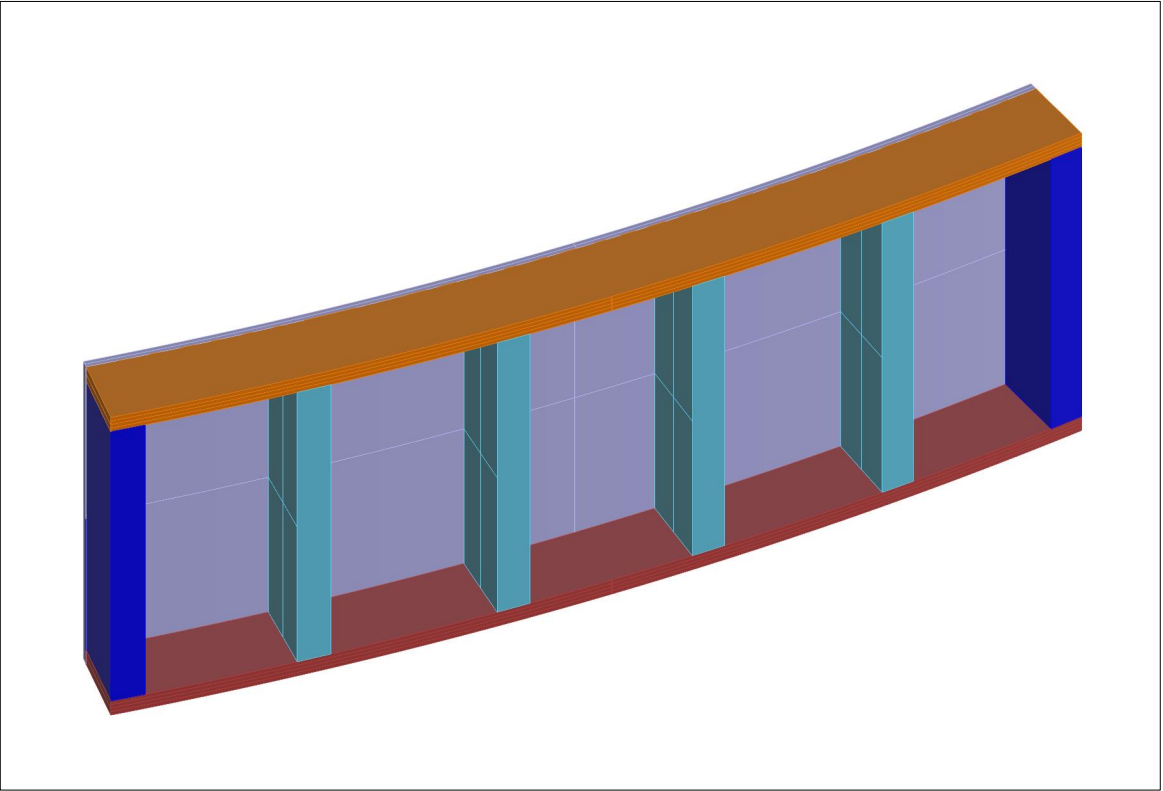

PANEL 7 LAYOUT

GENERAL NOTES

- 1. ATTACH STUDS TO PLATES USING 2 FASTENERS
- 2. ATTACH CASTING FACE TO FRAMING UTILIZING THREE SCREWS PER STUD, ONE INTO THE UPPER REGION OF THE STUD, ONE IN THE CENTER, AND ONE IN THE LOWER.



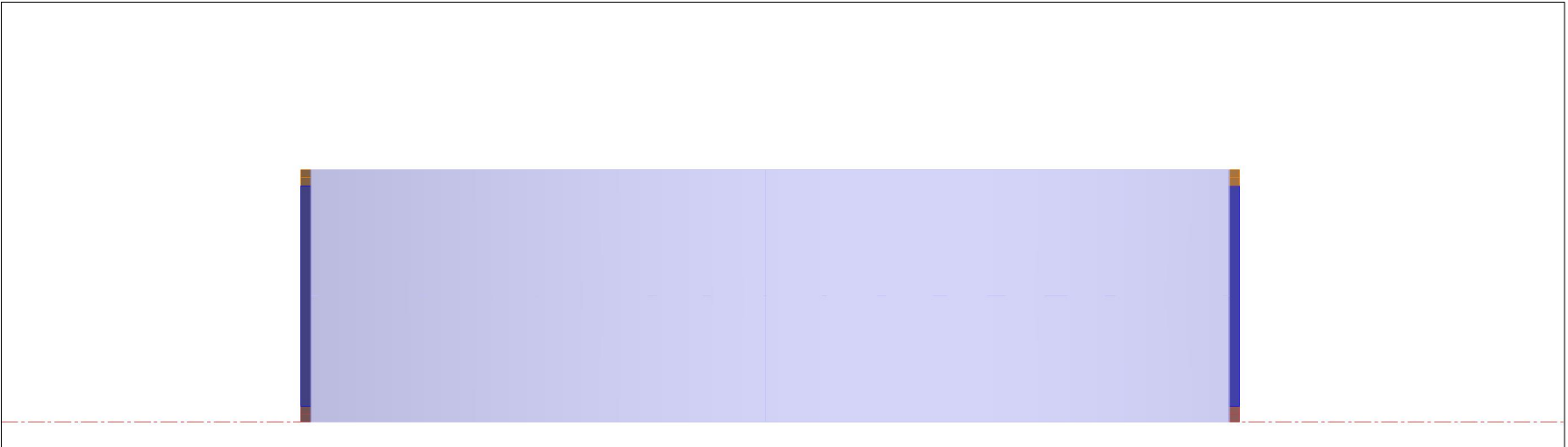

PANEL 8 CASTING FACE ELEVATION      SCALE 1-1/2" = 1'

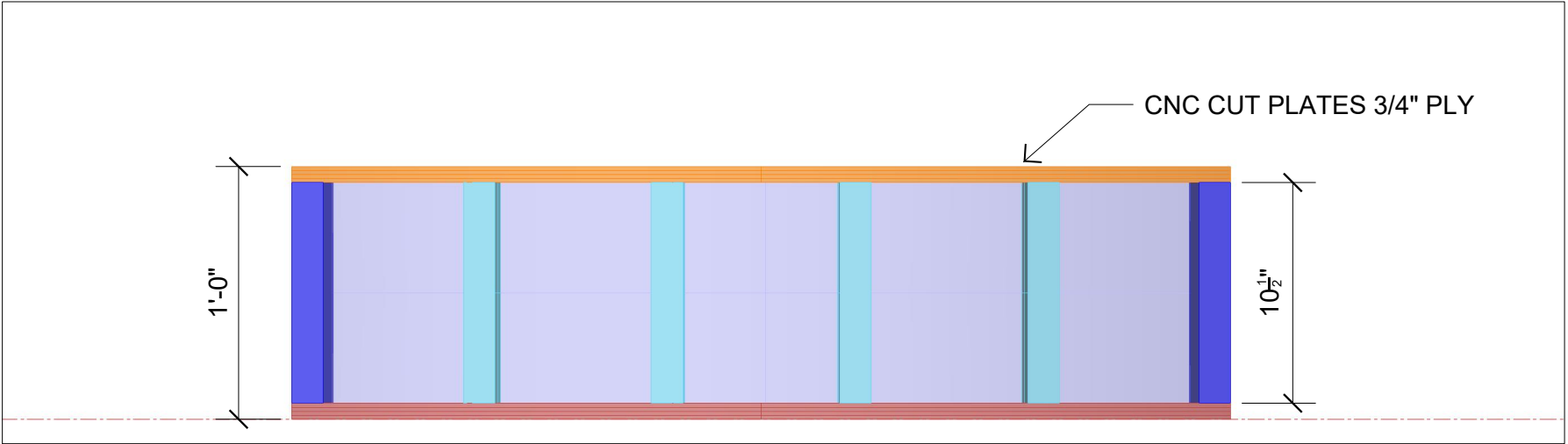

PANEL 8 FRAMING ELEVATION      SCALE 1-1/2" = 1'

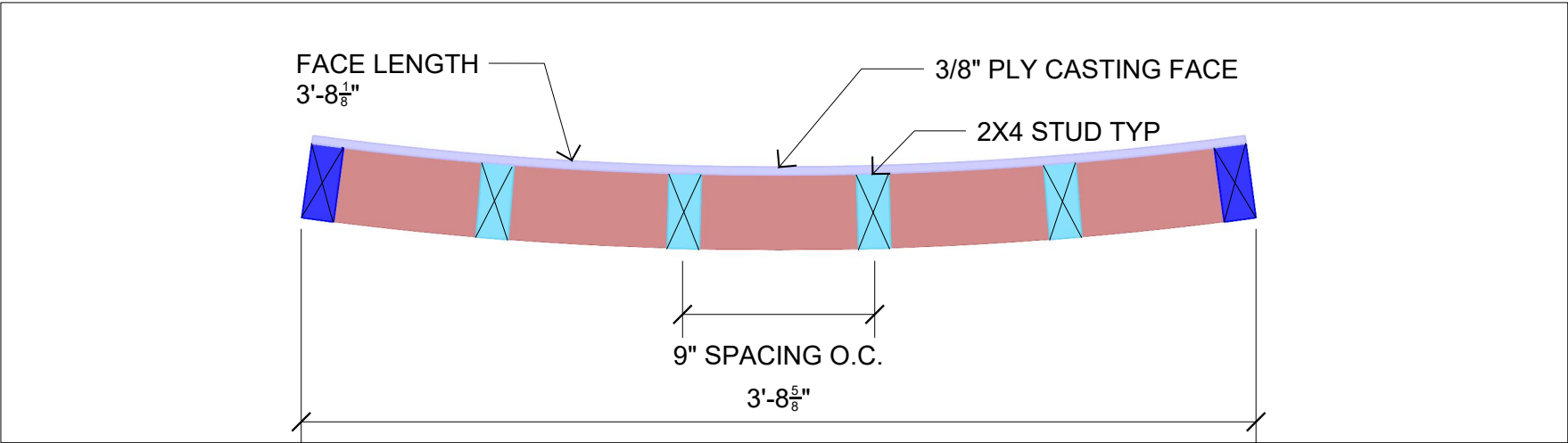

PANEL 8 PLAN      SCALE 1-1/2" = 1'

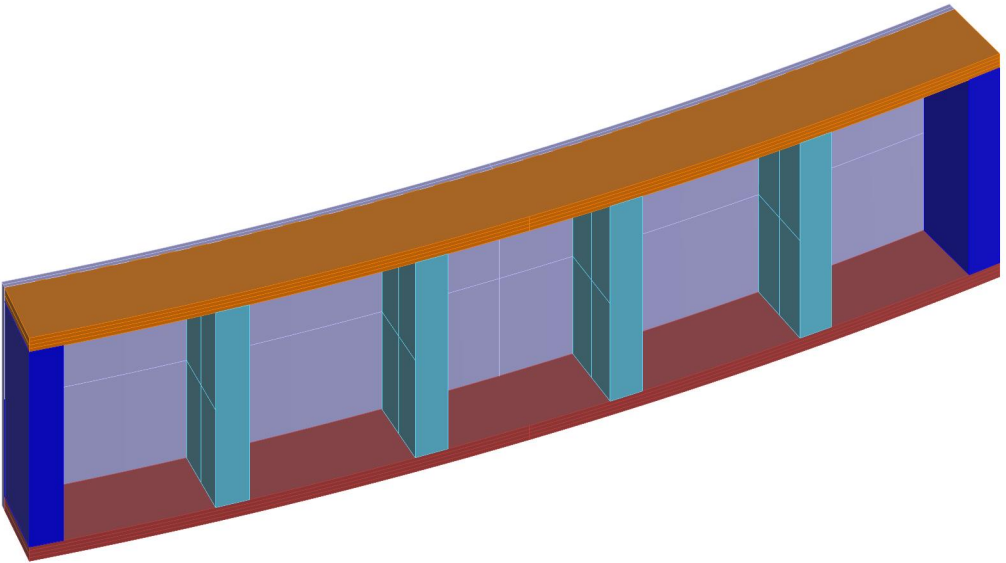

PANEL 8 LAYOUT

GENERAL NOTES

- 1. ATTACH STUDS TO PLATES USING 2 FASTENERS
- 2. ATTACH CASTING FACE TO FRAMING UTILIZING TWO SCREWS PER STUD, ONE INTO THE UPPER REGION OF THE STUD AND ONE IN THE LOWER.